

Stacionāra "Gaiļezers" zvanu centra paplašināšanas skice

arh. Vita Rauhvargere
17.07.2020.

ZVANU CENTRA PLĀNS M1:100

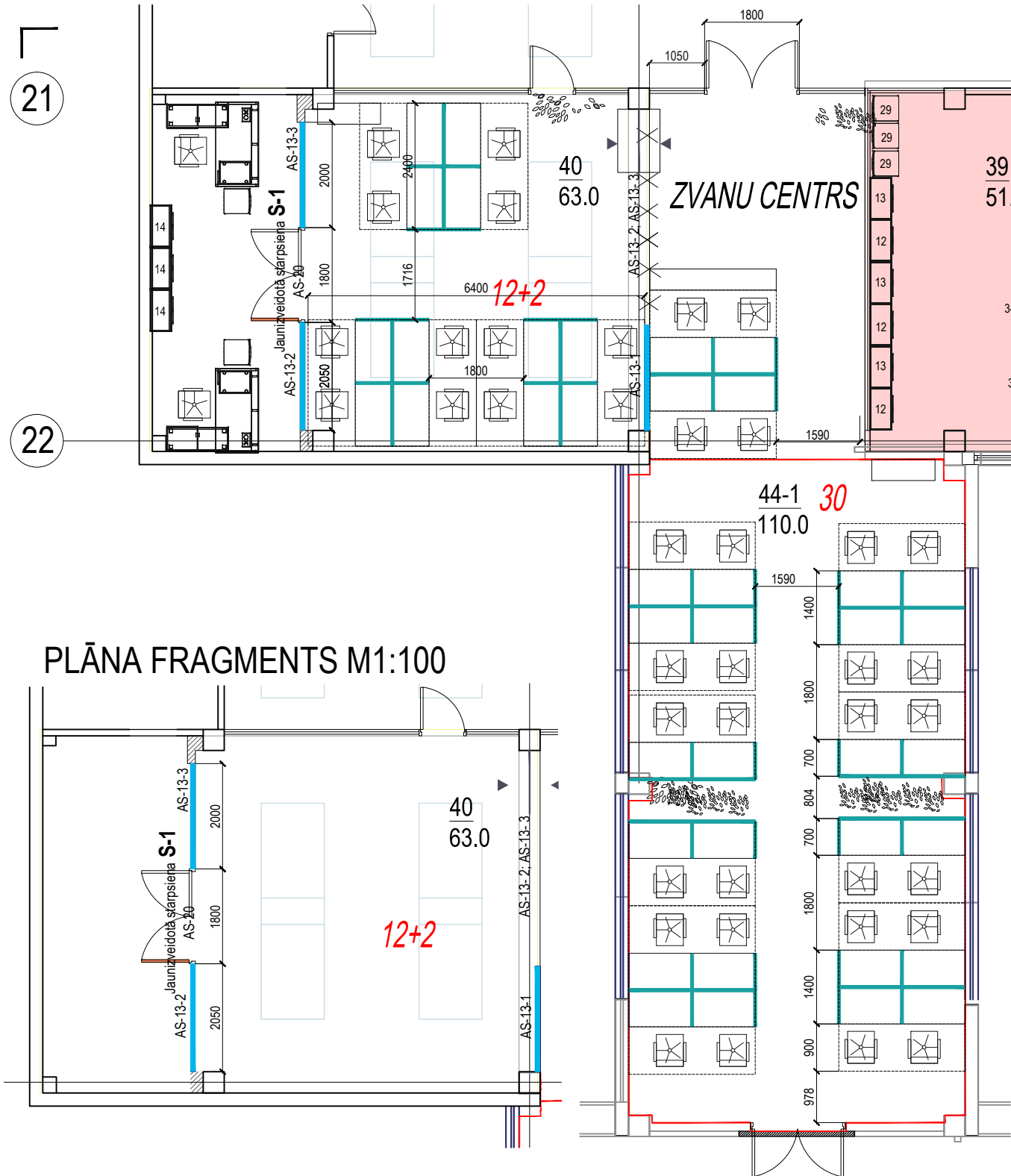

ESOŠĀS DURVIS AR VIRSLOGU (AS-20)

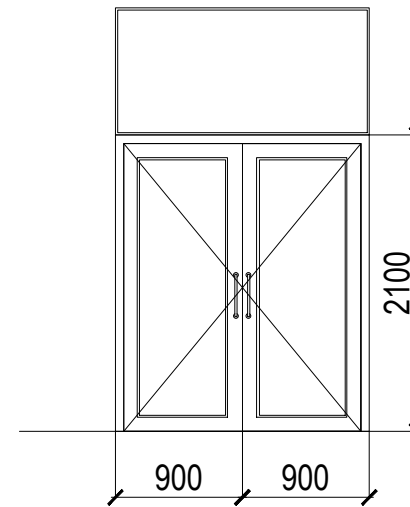

ESOŠĀ STARPSIENA (AS-13) skats no zvanu centra telpas

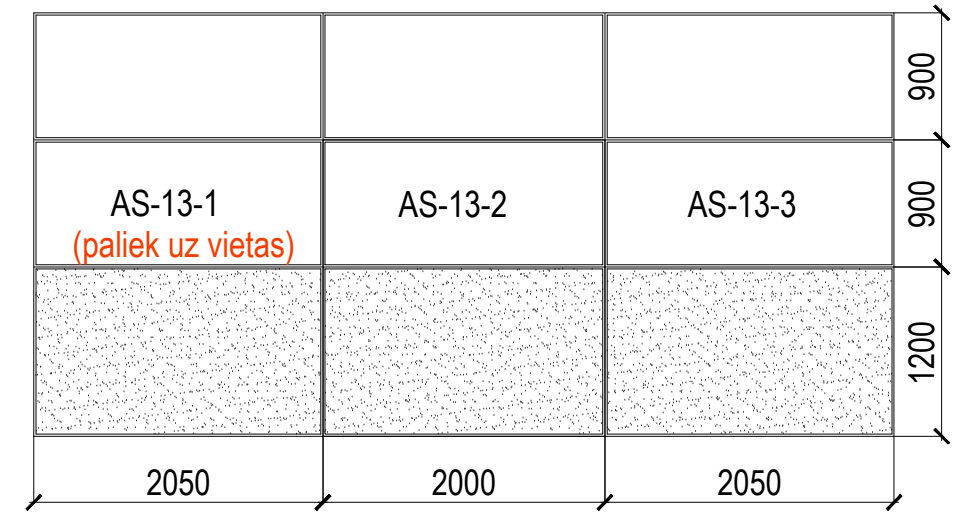



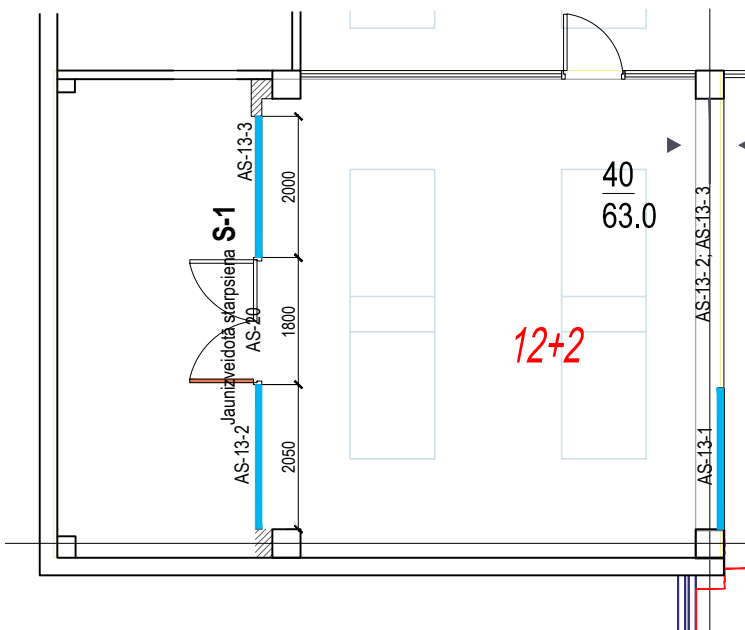

PLĀNA FRAGMENTS M1:100

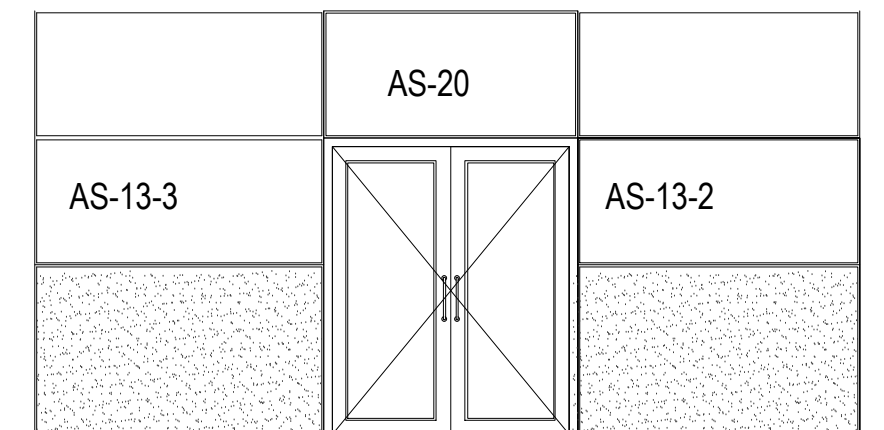

JAUNIZVEIDOTĀ STARPSIENA ar DURVĪM UN VIRSLOGU starpsiena S-1



APZĪMĒJUMI

-  darba galds 1200x700 ar skaņu ierobežojošu konstrukciju, ergonomisks darba krēsls
-  darba vietu grupu sadalīšana ar stiklotu starpsienu
-  personīgo mantu skapīšu bloki
-  alumīnija stiklotas durvis ar virslogu (aktīvā vērtne- labā)